



Annual Report

HUMANITIES LAB | 2013-2014 | LUND UNIVERSITY





“[...] the Humanities Lab has emerged as a world-class facility.”
(HTRQ14)

Annual Report 2013-2014

The period 2013-2014 has been eventful for Lund University Humanities Lab. We have expanded with an increase in users, staff, externally funded new research projects, new collaborations, courses, seminar series, a string of visiting scholars, and importantly, a set of new lab facilities. We have also successfully undergone an external scientific evaluation, hosted two major international conferences (ECEM 17; Culture, brain, learning), a range of workshops, and been targeted for Lund University's Fund Raising campaign.

The physical expansion has been particularly significant. In 2013 we inaugurated the Digital Classroom. This is a full-scale lab equipped with 25 eye trackers, one at each student seat, financed by Knut and Alice Wallenberg's Foundation and by Lund University's former Committee for research infrastructure. In 2014 we inaugurated two new facilities in the new building for the departments in the Joint Faculties of Humanities and Theology, LUX. We now have a custom-built motion capture lab ready for 3D and virtual reality, and a state of the art audio and video studio called the LARM studio (Ljud, Animation, Rörliga bilder, Musik, ('Sound, Animation, Moving images, Music'). We are grateful to Einar Hansen's Allhems Foundation for the generous financial support to equip the LARM studio.

The Lab has continued its activities and engagement with national and international networks in the academic arena and in interaction with industry, education, and cultural institutions. For example, we are engaged in the Universitas 21 network on issues surrounding Digital Humanities and we have also launched a new seminar series on Digital tools in the Humanities. In interaction with the museum world, Lab members have for example developed a 3D-film of a Roman villa now displayed at Millesgården, a Stockholm museum. In 2014, the Lab became a Knowledge-centre in SWE-CLARIN, a national consortium for language technology. We continue to provide training in the technologies at hand through workshops and courses open to researchers, teachers, and PhD students, as well as a steady stream of demo sessions, method seminars, etc. In a successful outreach project, Lab members have worked as in-house-scientists in upper secondary schools in the region.

In 2014, the Lab underwent an external scientific evaluation (the so-called HTRQ14). We are very proud of the fact that the external research examiner's report assigned top marks to the Lab (Excellent, mark 5), stressing that the variety and quality of the research makes it a "world-class facility".

As should be clear from the pages of this Annual report 2013-2014, the Humanities Lab is a vibrant, dynamic environment where the Humanities, Theology, and Social sciences can tackle the scientific challenges ahead.

Marianne Gullberg
Director of the Humanities Lab
Feb. 2015



Introduction

Lund University Humanities Lab is an interdisciplinary research and training facility financed by the Joint Faculties of Humanities and Theology (JFHT) at Lund University. It is open to scholars, teachers and students at these faculties but also to actors across Lund University campus and beyond. We host technology, methodological know-how, data management and archiving expertise, and a wide range of research projects. Lab activities are centered around the Humanities with research targeting issues of communication, culture, cognition and learning, but many projects are interdisciplinary and conducted in collaboration with the Social sciences, Medicine, the Natural sciences, Engineering, and e-Science. We provide training in hosted technologies and related methods through long and short courses, seminar series, and guided demo sessions. We are also an arena for collaboration between academia and external stakeholders in education, industry, and cultural institutions locally, nationally, and internationally. This interaction manifests itself in the building of long-term partnerships with the educational system such as secondary schools, and in the joint development of hardware and software solutions, the development of measurement standards, and in networking widely on issues of research infrastructures, data storage and processing. The Lab is a dynamic environment enabling scholars across the JFHT to combine traditional and novel methods, and to interact with other disciplines.

New facilities

In the period 2013-2014 the Humanities Lab expanded physically in significant ways. In 2013 we opened a new facility called the Digital Classroom in the existing Lab. In August 2014 we inaugurated two new facilities in a new building for the Joint Faculties of Humanities and Theology called LUX. The Humanities Lab is therefore now located at the Centre for Languages and Literature (in Swedish Språk- och litteraturcentrum, abbreviated SOL), and at LUX: the Humanities Lab@SOL and @LUX (see the maps overleaf).

THE LAB @SOL

The Digital Classroom was inaugurated in 2013 in the Lab housed at the Centre for Languages and Literature (@SOL). This is a full-scale lab equipped with an eye tracker at each one of 25 student seats. It is financed by Knut and Alice Wallenberg's Foundation and by Lund University's former Committee for research infrastructure. The classroom is the empirical home of a big research project on learning (Holmqvist: *EyeLearn: Using visualizations of eye movements to enhance metacognition, motivation and learning*) funded by the Marcus and

Amalia Wallenberg Foundation.

– We are at a defining moment in the development of teaching methods, says Kenneth Holmqvist. Many of the future e-readers will have built-in eye-tracking equipment and it is important that we learn to exploit the opportunities offered.

A considerable amount of method development has been necessary in order to exploit the facility to the full. It is now in regular use in a series of studies. Together with other major grants the facility and the project contribute to a steadily growing emphasis on learning in Lund.

THE LAB @LUX

In August 2014 the Lab opened two new facilities in the new LUX building (@LUX). The motion capture lab is a custom-built facility for motion capture, 3D, and virtual reality work. The big flexible space and the adjoining control room can be used for 3D data collection and management, but also for projection and other types of work, for example on VR-applications. Contiguous to the mocap studio are also two new experimental booths for computer based experiments.

The LARM studio (Ljud, Animation, Rörliga bilder, Musik, i.e. Sound, Animation, Moving images, Music) is another custom-built facility, a state of the art audio and video studio. It is equipped with professional level recording, mixing, and analysis tools, professional lighting, and a set of basic instruments. It is big enough to house both performers and a small audience. There is also additional work space for analyses. The studio complements the anechoic chamber @SOL and opens new possibilities for conducting research on human interaction, rhetoric, musical and theatrical performance, debate and argumentation skills, etc. The studio equipment has very generously been funded by the Einar Hansen Allhems Foundation.

Research

Organisationally, research in the Lab is of two kinds. Most research in the Lab is conducted by scholars whose research grants and research groups are located in their home departments. These scholars use the Lab equipment to conduct their empirical studies. Examples of such user groups are scholars working in the inter-faculty Linnaeus Centre *Thinking in Time: Cognition, Communication, Learning* (CCL, financed by the Swedish Research Council), but also scholars with smaller research projects (see e.g. the research data base of the JFHT <http://www.ht.lu.se/en/research/research-database/> Note that this database does not exhaustively list all the projects in the Lab since projects administratively situated outside the JFHT are not listed).

The Lab also hosts externally funded research projects of its own with grants and research groups located in the Lab. Currently, the Lab has four such large-scale projects with affiliated members: an ERC project entitled *Landscape, Cognition, Landscape* (LACOLA, Burenhult); a major collaborative project between Lund, Stanford and Umeå Universities as part of a Wallenberg Network Initiative entitled *Culture, Brain, Learning* (Strömquist, Heller, Gullberg, Smith), funded by the Knut and Alice Wallenberg Foundation; a project called *EyeLearn: Using visualizations of eye movements* to enhance metacognition, motivation and learning (Holmqvist), funded by the

continue on page 8



Brain



Ears



Eyes



Mouth



VR



Motion

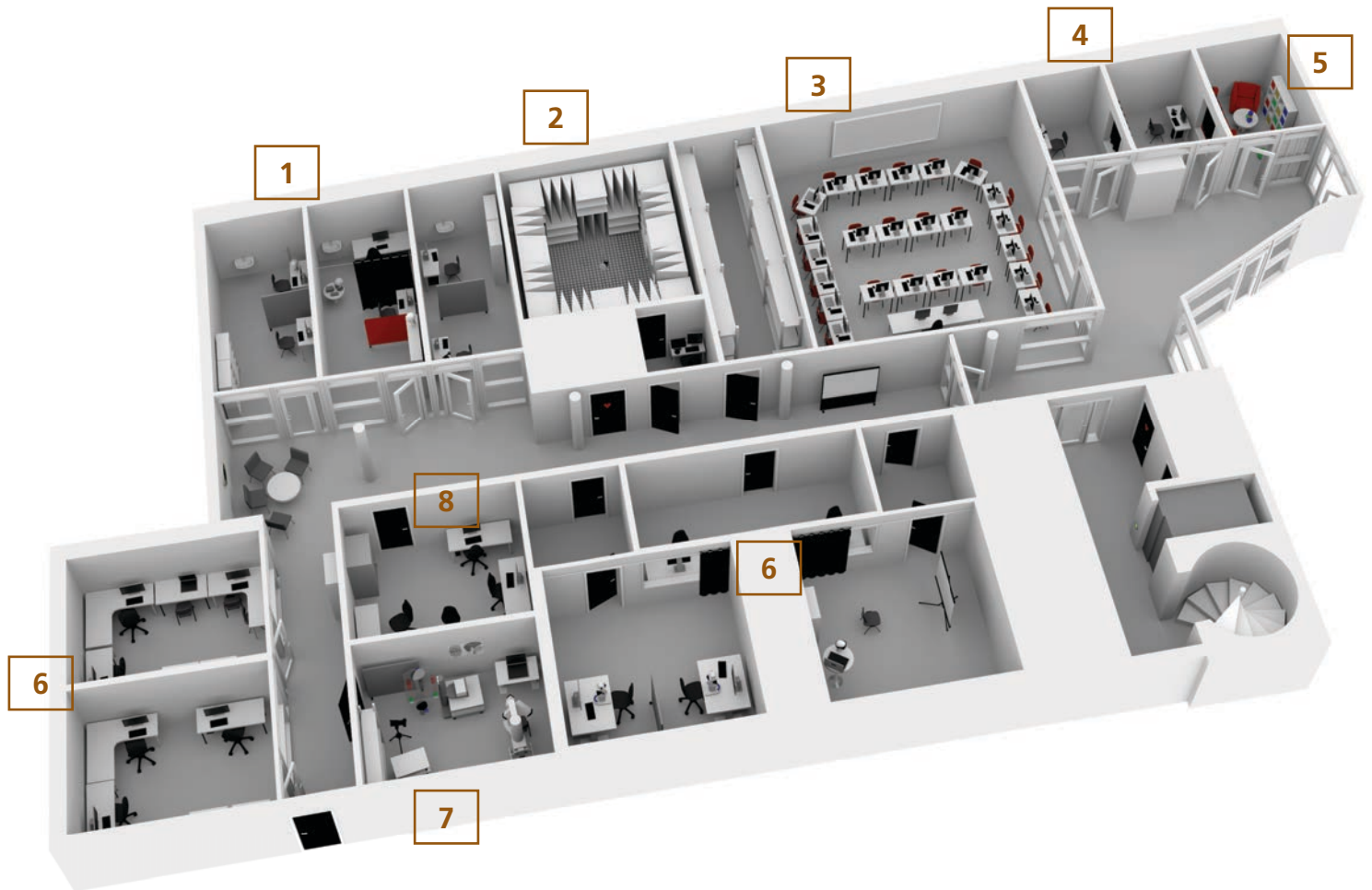

Humlab @SOL:

- | | |
|------------------------------------|-------------------------|
| 1. EEG studios | 5. Baby Lab |
| 2. Anechoic Chamber | 6. Experimental Studios |
| 3. Eye Tracking, Digital Classroom | 7. Articulography |
| 4. Experimental booths | 8. Analysis room |

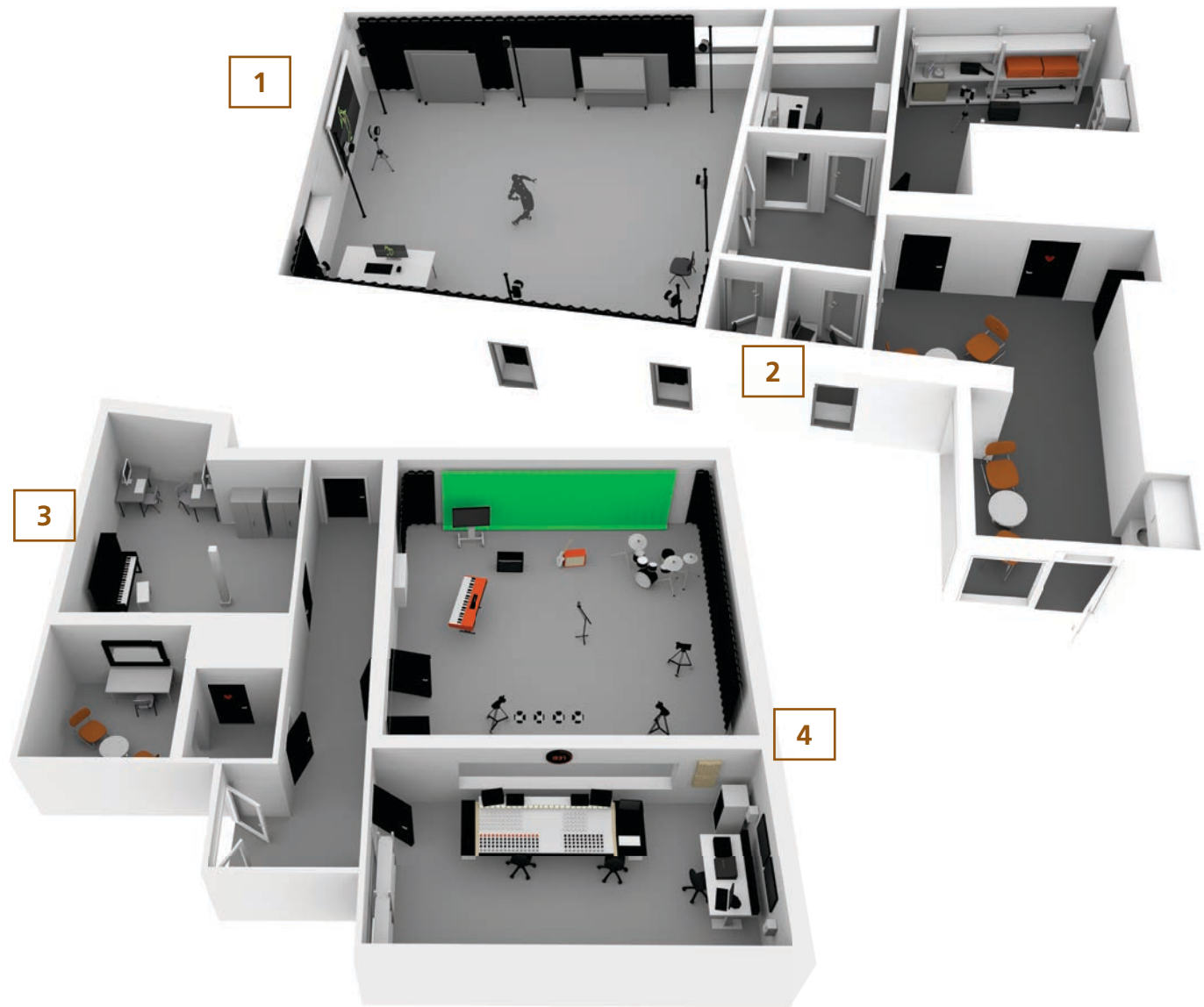

Humlab @LUX

1. Motion Capture, Virtual Reality

2. Experimental booths

3. Analysis room

4. Audio / Visual (LARM-studio)

Marcus and Amalia Wallenberg Foundation; and a Wallenberg Scholar grant on *Embodied bilingualism* (Gullberg) funded by the Knut and Alice Wallenberg Foundation.

The Lab's total user base currently approximates some 150 users.

Eye-tracking. In 2013, Lab members organised and hosted the world's largest conference on eye movements, ECEM17 (see box) in collaboration with the *Eye Movement Researchers' Association* (EMRA), of which Holmqvist is president, and the association *Communication through Gaze based Interaction* (COGAIN), whose organisation chair is Mulvey. Holmqvist has also hosted an international postdoc on a stipend in 2014 (Zemblys). As part of these international associations, scholars in the Lab have conducted a large-scale international comparative eye data quality (EDQ) study in 2014. More than 20,000 recordings were made from 194 people, the largest data recording ever conducted in the Lab. Its scope is unique in the world also through the collaboration between eye-tracking labs and manufacturers. Holmqvist and Lab members also organize the *Lund Eye Tracking Academy* (LETA) workshop twice a year to provide training in eye-tracking. LETA has now trained over 400 scholars worldwide. The textbook on eye tracking methodology, authored by Holmqvist and other members of the Lab and first published by Oxford University Press in 2011, is widely cited and is now being revised for its second edition to be published in 2015.

The research project *EyeLearn: Using visualizations of eye movements to enhance metacognition, motivation and learning* (Holmqvist), based in the Digital Classroom, began in earnest in 2013 when a doctoral student was recruited (Oliva). A postdoc will start in 2015 (Niehorster). The work builds bridges between education, training, science and research using eye-tracking to study students' information processing, teachers' immediate feedback on students' visual attention, and the effect on learning. In addition to the international connections, the project has important links to the LU Department of Education at Campus Helsingborg. In this context, the work has been targeted as a promoted area of the LU Fund

raising campaign.

Other members investigate deformations in the lens of the eye, and algorithms for detecting fixations (Nyström, R. Andersson). In 2014 R. Andersson was granted an international postdoc by the Swedish Research Council to pursue this line of research in 2015. This work also involves a joint doctoral student with the Engineering Faculty (L. Larsson) funded by the strategic research area e-Science (<http://essenceofscience.se>). Members are also involved in the Wallenberg project *Culture, Brain, Learning*, specifically working with the Stanford group on clinical interventions for cognitive deficits in Down syndrome (Mulvey). Data were collected in Stanford in 2014 and some results were presented at the conference *Culture, Brain, Learning*, organised in Lund in Nov. 2014 (see box).

Electrophysiology. Work using electrophysiological measurements of brain activity has grown significantly in 2013-2014. To meet the growing demand for training from advanced students and researchers, the Lab organised a workshop on capping for novel and experienced users in May 2013 (A. Andersson). In connection with an update of acquisition and analysis software (Curry7) Lab members also organised a workshop on the new system (A. Andersson, Dewhurst).

Research projects exploiting the technology include a study of how adult German and English second language learners of Swedish process Swedish word orders (Gullberg, A. Andersson, Sayehli). The Wallenberg Network Initiative linking Lund and Stanford, *Culture, Brain, Learning*, has a substantial electrophysiological component (Gullberg, M. Johansson, M. Lindgren) which involves three postdoctoral subprojects that use these techniques to improve our understanding of memory. The projects examine crosslinguistic effects on comprehension, inferencing, and memory for narratives (A. Andersson); the effects on episodic memory retrieval of attention and information availability (R. Johansson); and also of contextual representations (Bramao). Two PhD projects in linguistics started in 2013-2014 examining how grammar and prosody interact in Swedish (Söderström, Gosselke). A number of MA projects are also en route.

Highlight: ECEM

Members of the Eye-tracking group at the Humanities Lab, the association COGAIN (*Communication through Gaze based Interaction*), and EMRA (the *Eye Movement Researcher's Association*) organised the 17th European Conference on Eye Movements (ECEM.), Aug. 11-16, 2013, preceded by a series of Method workshops August 7-10, 2013.

ECEM is the largest conference on eye movements in the world whose aim is 'to exchange information on current research, equipment and software'. It brings together neurophysiologists, psychologists, neuropsychologists, clinicians, linguists, computational and applied scientists, engineers and manufacturers interested in the movements of the eyes.

The conference took place in the student union building, AF Borgen, and hosted some 580 participants. The method workshops took place at the Centre for Languages and Literature and the Humanities Lab and covered such topics as how an eyetracker works – looking inside the black box, analyses of eye movements with linear mixed models using R, and eye tracking in the 'real world'.



Conference Chairs: Kenneth Holmqvist and Arantxa Villanueva

Conference Organiser: Fiona Mulvey

Scientific Board: Halszka Jarodzka (Chair), Ulrich Ansorge, Kenneth Holmqvist, Rudolf Groner, Reinhold Kliegl, Jukka Hyönä, Päivi Majaranta and Fiona Mulvey

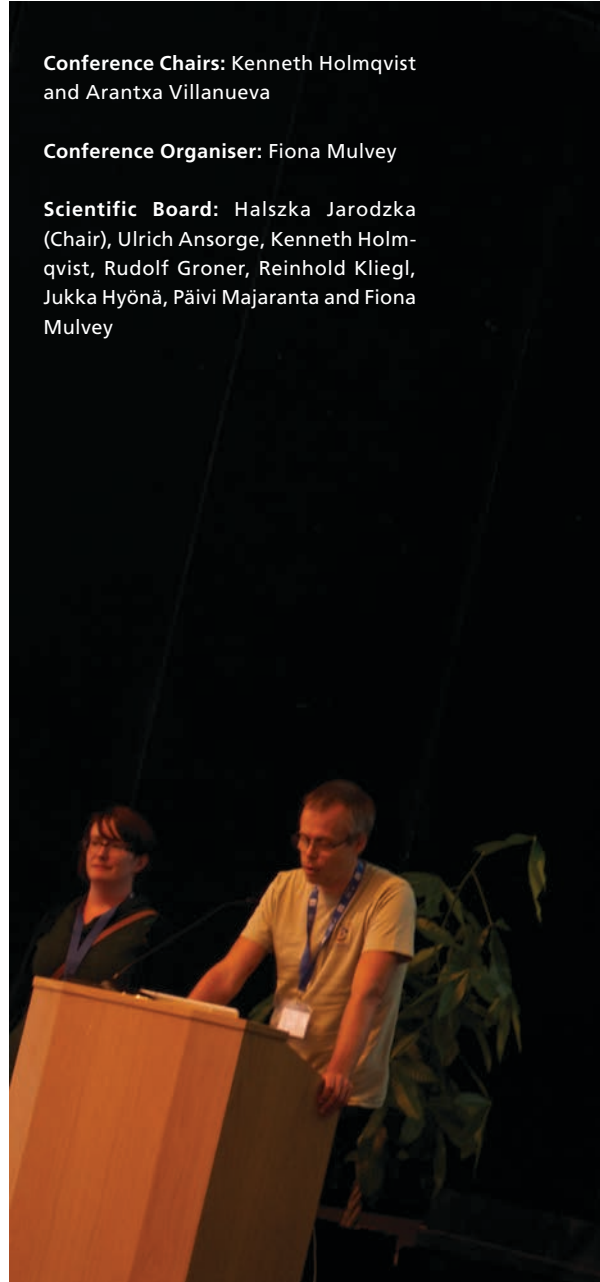



3D scanning, Virtual Reality (VR). The use of 3D and VR techniques continues to grow, partly due to the very successful method development done in collaboration with Ingvar Kamprad Design Centre at the Engineering Faculty and the Dept. of Archaeology and Ancient History, with immediate application in current research (S. Lindgren, C. Larsson, Dell'unto). The work focuses on the collection of digital data in the field of cultural heritage. Lab members have numerous international collaborations, involving the training of students in 3D-documentation in Peru, combining 3D data from the scanner with 3D data from airborne photogrammetry. A project with the University of Queensland, Australia, seeks to develop augmented reality applications to enhance and preserve art by indigenous artists (S. Lindgren, Nicoll). The work with the *Swedish Pompeii project* (Leander-Touati) intensified in 2013-2014. All scans of the city block known as Insula V1 were merged and placed into a GIS system linked to the project database and website. Some parts of the city block were reconstructed. A national exhibition based on the work of the Swedish Pompeii project opened at Milesgården in Stockholm in Sept. 2014. Part of the exhibition is a 3D-film showing the house of Caecilius Iucundus based on on-site 3D-scans. In 2013 Lab members co-organised the Swedish section of the Conference *Computer Applications and Quantitative Methods in Archaeology* in Lund. National scan projects in Sweden include internal and external scans of the church in Dalby, the oldest church in Skåne; the St. Petri Church in Malmö; the cave *Stora Förvar* at Stora Karlsö outside Gotland which harbours the remains of the very first people on the island.

Motion capture. The use of motion capture increases steadily. In October 2014, we upgraded the hardware equipment to improve recording capacity and performance more generally. A range of projects is now using motion capture in the context of virtual reality to examine speakers and their gestures. The Linneaus Centre *Thinking in Time: Cognition, Communication and Learning* uses motion capture to build virtual language users (Gulz, Haake, Gullberg). In particular, a new PhD project explores gesture-speech integration by building virtual agents based on mocap recordings of real speakers and then experimentally manipulating them (Nirme). Gullberg's Wallenberg Scholar project *Embodied bilingualism* exploits the same techniques to build and examine speech-gesture profiles of native and non-native speakers of Swedish, French and English, in order to probe issues of bimodal language processing in mono- and bilingual speakers. A new PhD student started in this project in 2014. This project has also been targeted for the LU Fund raising campaign. A PhD project started in 2013 in Cognitive science uses motion capture to examine human-robot interaction (Osk-Ingvardsdottir). Other student projects using motion capture have targeted human gait, for example.

Combined motion capture and VR work has led to collaborations with cultural institutions. In 2013, the exhibition *Petroglyphics* at Österlen's museum in Simrishamn

contained elements based on motion capture recordings and visualizations (Chapelon). Similarly, a performance and artistic installation based on motion capture data of a classical guitarist was performed at KTH in Stockholm (Östersjö). This particular event involved the development of a technique combining standard motion capture with 3D data from video cameras. This work has led to the initiation of a network of all museums in Skåne for digitization and visualization of cultural heritage.

Acoustic facilities. The acoustic facilities in the Lab have a steady user base working with data collection, analysis and education. The anechoic chamber is used in studies on vocal communication and voice treatment (the Linnaeus Centre *Cognition, Communication, Learning*), in the production of educational materials (pronunciation exercises, for example), and auditory research stimuli and materials for phonetic analysis. The articulograph is used in phonetic projects within the Linnaeus centre CCL and in individual research projects on the Swedish vowel system and compound word accentuation in Estonian Swedish (Schötz), for example. In Sept. 2014, we acquired a second, upgraded articulograph (AG501) and organised training and method development sessions for both data acquisition and post processing (Schötz, Frid). In September 2014 a new PhD project in linguistics also started on tonal, facial and articulatory gestures in Swedish prosody (Svensson) using the new equipment. The new LARM studio at LUX (see New facilities) complements the other acoustic facilities.

Corpus server. The Humanities Lab corpus server offers secure, long-term storage of structured and meta-described digital research data. The corpus server can also function as a collaborative workspace, where a group of researchers can download, edit, and upload data and metadata. Metadata are publicly visible, browsable, and searchable through the corpus browser, while the data themselves are password-protected. The corpus server has been in place since the Lab's

inception, but its use has expanded in the period 2013-2014. The growth is due to the success and development of projects such as the *Language, Cognition, Landscape* project and the *Digital Multimedia Archive of Austroasiatic Intangible Heritage* RWAAI (both Burenhult), documenting threatened languages across the world through the combination of audio, video, annotation data, and GIS data. The Lab recruited a new corpus manager in 2014 (J. Larsson) to meet the pressures. A further important development is the development of the Lab as a Knowledge Centre in SWE-CLARIN in 2014, a national consortium linked to the European CLARIN, a European Research Infrastructure Consortium (ERIC) devoted to developing language technology and language resources as e-science.

Other areas. Other areas that have grown in 2013-2014 include work on linguistic processing using a range of techniques (Tutunjian, Wiklund), and multimodal analysis of human behaviour (speech and gesture) with several projects connected to Gullberg. Among these is a project on multimodal disfluency in different child and adult populations (Graziano), the role of gestures in adult word learning (Kutchsh), multimodal conceptual metaphors (Christensen), and gestural cohesion in discourse (Debreslioska, Campisi).

Work has also continued using keystroke logging technology to study the writing process (Sahlin, V. Johansson et al.), especially instantiated in a big project entitled *Keystroke logging and peer observation – new tools for childrens' text writing* (Sahlin, V. Johansson), funded by the Marcus and Amalia Wallenberg Foundation. The project implements and evaluates a model for training writing skills for school children with and without typical linguistic development.

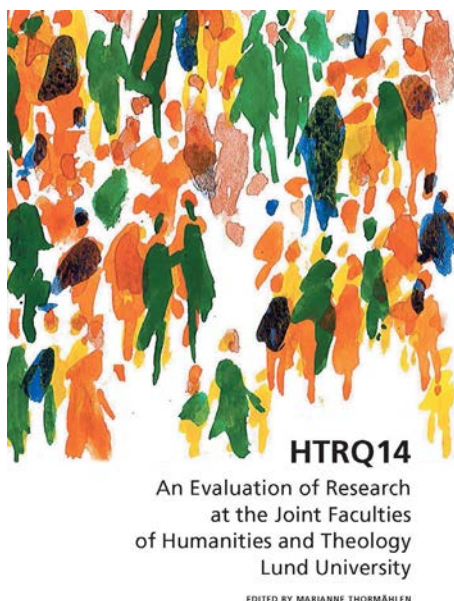

HTRQ14 Research evaluation

The Joint Faculties of Humanities and Theology (JFHT) initiated an external evaluation of research across the Faculties at the end of 2012 which was presented in 2014. Reviewers considered both the width and depth of research (for all criteria, please consult the HTRQ14 report (<http://www.ht.lu.se/skriftserie/serie/htrq14/>). The Humanities Lab was also assessed by Prof. David Birdsong of the University of Texas at Austin. The external examiner's report assigned top marks to the Lab (Excellent, mark 5), stressing that the variety and quality of the research makes it a "world-class facility".

Training and Teaching

An important part of the Lab activities is centered around training, teaching, and consultations internally and externally on such diverse topics as how to use motion capture and 3D scanning in archeology, how to cap participants in an EEG study, how to create a linguistic corpus and annotate video data, how to programme your own experiment. This work is motivated by the goal to facilitate and enable interdisciplinary, intra-and inter faculty research, and increase access to the technological resources that require advanced methodological skills.

Long courses, taught by Lab members, are offered to PhD students for credit, and to senior scholars at the Joint Faculties, from across campus at Lund University and also from other universities (six in 2013 and six in 2014). Lab members are also involved in supervision (e.g., seven PhD students, seven master's students and two bachelor students). In 2014, the Lab recruited a new pedagogical developer (Splendido) responsible for developing and organizing short courses to meet the demands of new users asking for specific course elements (six in 2013). *Lund Eye Tracking Academy* also offers intensive workshops on eye tracking with many international participants.

The consultation work is also extensive (see p 22). Methodological and statistical guidance for research projects within and outside the Lab continues to grow, occasionally including programming. In 2013 the Lab hired a full time programmer (Garde) to complement the work by the in-house



methodologist (van der Weijer) to meet the increasing needs for sophisticated help in this domain. The Lab course on statistics (*Statistical analysis for the behavioural sciences I*) was also extended in 2013 with a follow-up course, *Statistical analysis for the behavioural sciences II*.

National and International Collaborations

Lund University Humanities Lab and its members have thriving local, national, and international collaborations and networks, some linked to individual scholars, others more general to the Lab as a unit (see p 22).

The Lab is involved in technical collaborations with manufacturers of eye tracking equipment and articulography located internationally. Lab members with expertise in these areas also provide advice to other labs nationally and internationally on set-ups, standards, and best practice. In the domain of eye-tracking the Lab is a world leader in terms of standardisation and method development, with several Lab members heading international bodies (Holmqvist is president of the *Eye Movement Researchers' Association*; Mulvey is the organisation chair of the association *Communication through Gaze based Interaction*, and both are involved in the *Committee for Eye Data Quality*). In the field of 3D scanning, Lab members have several international collaborations which often involve field work with the Lab equipment in Peru, Egypt, Italy, etc. (S. Lindgren, C. Larsson). These are also involved in a regional network of all museums in Skåne for digitisation and visualisation of cultural heritage data.

In 2013 the Swedish research Council approved a proposal for Swedish membership in CLARIN, the *European Common Language Resources and Technology Infrastructure* (<http://clarin.eu/>). SWE-CLARIN (<http://sweclarin.se/>), set up during 2014 and administered from Gothenburg, links 9 Swedish institutions around issues of language technology. Lund is a so-called Knowledge centre (K-centre). As such, the Lab provides tools and expertise related to language archiving, corpus and (meta-)data management, with a continued emphasis on multimodal corpora, many of which contain Swedish resources, but also other (often endangered) languages, multilingual or learner corpora. Current work targets automatic data retrieval from multimodal data sets, as well as the linking of measurement data (e.g. EEG) or

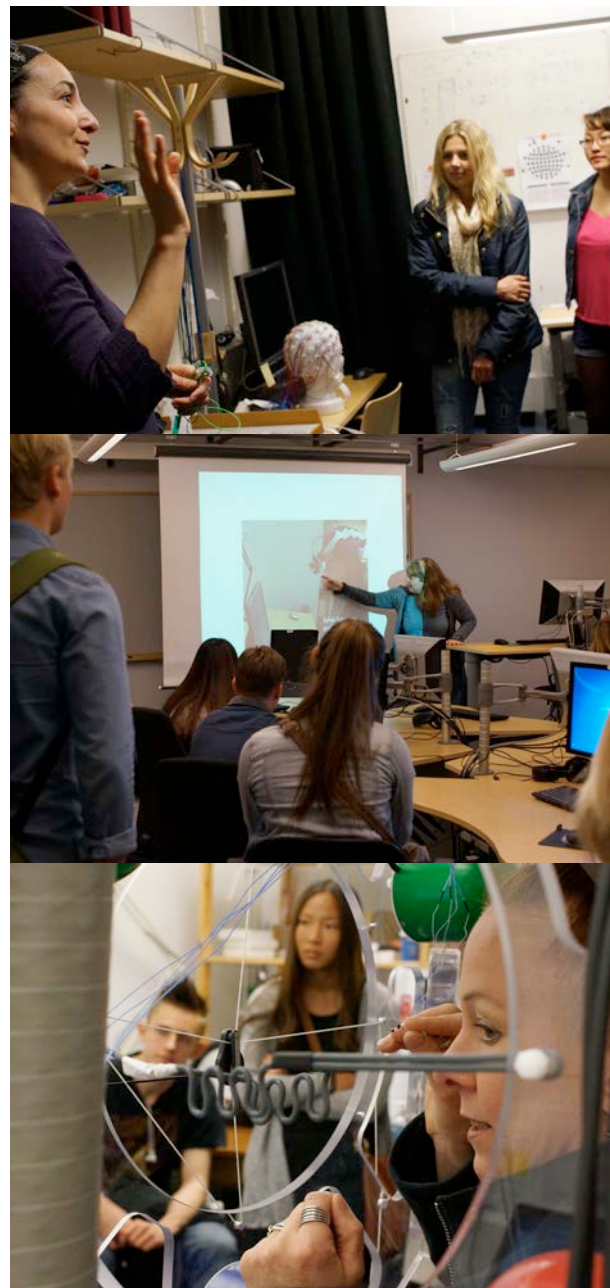

geo-demographic data (GIS, GPS) to language data (audio, video, text, annotations). In 2014, the Lab hired a local SWE-CLARIN coordinator (Frid). The Humanities Lab also continues its collaboration with *The Language Archive* at the Max Planck Institute for Psycholinguistics. The Humanities Lab corpus server is linked to this archive and hosts a collection of fully documented and freely available multimodal language data, part of a much wider network of similar resources.

The Lab continues its partnership with eSENCE, a national strategic research program in e-Science (<http://essenceofscience.se/>) involving the universities of Uppsala, Lund and Umeå. The overall enterprise focuses on the development of tools for handling, storing and retrieving research data in digital form. In 2013, the Lab elaborated on the ongoing joint PhD project with the Engineering Faculty on event detection in eye movement data (L. Larsson, Nyström) by adding a postdoc project looking at sensor-near analysis of combined brain activity and eye movement (R. Andersson). The Lab is also linked to Lund Bio-Imaging Centre in this network, where work is underway to find a joint solution for optimising data flows, large databases, heavy data computation, and data visualisation. These needs continue to grow due to the increased use of the corpus server as well as by the increased volume of sensor data. In 2014, the lab also saw the start of a joint postdoc project with the Department of Applied Mathematics dedicated to development of statistical tools (Vang Andersen, Adalbjörnson).

The Lab is part of a Wallenberg Network Initiative linking Lund, Stanford, and Umeå Universities through generous funding by the Knut and Alice Wallenberg Foundation. This initiative promotes the exchange of technology and methodological expertise across all three universities, as well as technological compatibility. A large-scale research project is also embedded in the initiative. The Lund-Stanford project, entitled *Culture, Brain, Learning*, engages some 30 scholars in a range of subprojects across three domains: Narrative, Reading, and Improving learning. Lund contributes in all three domains in collaborative projects with Stanford (M. Johansson, M. Lindgren, R. Johansson, Bramao, Wagner, Mulvey),

partly also involving scholars in the Linneaus Centre *Cognition, Communication, and Learning* on topics of computer assisted learning (Gulz, Haake, Schwartz), and on so-called choice blindness (Hall), etc. The Humanities Lab serves as a hub for these activities, promoting the cross-fertilisation and fruitful exchange and expansion of ideas and networks.

The Wallenberg Network Initiative further links the Lab to HUMlab Umeå and work within Digital Humanities. In the autumn of 2014, the Lab launched a new monthly seminar series on *Digital tools in the Humanities* in collaboration with scholars from the JFHT (Göransson, Leander-Touati, Rubensson). Local as well as invited speakers from Sweden and abroad have addressed such issues as research libraries and research data management, digital multimedia language corpora as interdisciplinary meeting places and historical records of the future, and an introduction to a national research infrastructure for the Humanities in Denmark, the DigHumLab Dk. The seminar series serves as an important meeting place to foster collaborations with untapped parts of the scholarship at the JFHT.

The Humanities Lab is also a partner in a number of international centers such as the *Centre for Multilingualism in Society across the Lifespan*, Oslo, and the *National Centre for Reading and Educational Research*, Stavanger, Norway. The Lab also acts as the only Scandinavian partner in the network *PIRE: Bilingualism, mind, and brain: An interdisciplinary program in cognitive psychology, linguistics, and cognitive neuroscience*, funded by the NSF in the USA under the direction of Prof. J. Kroll, Penn State. The network includes 9 universities worldwide and focuses on training and exchange. In 2013-2014, the Lab hosted two American students and initiated a new research collaboration within the network (Gullberg, Jackson).

Many collaborations are found in the realm of learning. As part of a collaboration with a national graduate school for Foreign Language Didactics (FRAM), based in Stockholm, the Lab hosted a graduate level course on Information and Communication Technology in foreign language teaching in the spring of 2013 (V. Johansson, Granfeldt). The strong

Highlight: CBL

The conference *Culture, Brain, Learning*, held in Lund Nov. 19-21, 2014, was the third in a series of interdisciplinary conferences organised by the Wallenberg Network Initiative, bringing together the Humanities Lab at Lund, Stanford and Umeå University. The conference, generously funded by the Peter Wallenberg Foundation, targeted a key question at the intersection between the humanities and science: How can knowledge of the mind and brain contribute to our understanding of human culture and social behaviour, and how can we use the products of culture and the nature of social interaction to understand how the mind and brain develop, learns, remembers, and creates?

The conference brought together some 60 scholars from the humanities, social sciences, neuroscience, and education to discuss this central issue from different perspectives. The conference took place at the Grand Hotel in Lund and in the landmark building the Turning Torso in Malmö, and also included guided tours of the Humanities Lab.



Conference chairs: Sven Strömqvist, Lund University; H. Craig Heller, Stanford University; Marianne Gullberg, Lund University; Göran Sandberg, the Peter Wallenberg Foundation

Local committee: Marianne Gullberg (chair), Mikael Johansson; Magnus Lindgren; Maja Petersson, Lund University

Moderator: Mo Costandi

focus on learning can also be seen in a pilot collaboration with a network of upper secondary schools in the region, *Forskningsnätet Skåne* (<http://www.forskningsnatet.se>). Lab members worked as in-house-scientists in a class for a year introducing eye-tracking during a physics lesson (V. Johansson, R. Johansson, M. Nyström). The aim was to engage teachers and pupils in research. The project started in 2013 and ran for a year. In April 2014, a final event took place at the Lab@SOL where the results were presented to teachers and pupils.

The Humanities Lab continues to host many visiting scholars from all over the world for both short and long-term stays (see p 29). These visiting scholars contribute to the environment by generously giving guest lectures and engaging in scholarly exchange with the whole environment.

Lab members also regularly give invited scholarly talks about their own research both within and outside Lund University (see p 26). These activities contribute in important ways to building new connections. For example, in October 2014, Lab members were invited to present both the Lab and research activities at *COMPUTE*, a research school at the Science Faculty, Lund University, with a focus on scientific discovery using computer simulations. The presentations of work involving EEG (A. Andersson), eye-tracking (Nyström), and 3D data (Dell'unto) generated new connections which we hope will lead to new collaborations across the faculty lines at LU.

Visibility, access, outreach

The Humanities Lab organizes a wide range of events and demos, often with concrete demonstrations of ongoing research and hands-on elements for the participants (87 tours and lab demos in 2013-2014 for local, national, and international visitors). In 2013-2014 we hosted visitors such as the Boards of the Marcus and Amalia Wallenberg Foundation, the Gad

and Birgit Rausing Foundation, multiple visitors from the Fund Raising Unit at LU, and many scholars from all over the world (see p. 20-21). The Humanities Lab also participates in local open events such as the popular *Humanities Days* (HT-dagarna) organised by the Joint Faculties of Humanities and Theology, Lund City's annual *Night of Culture*, and interdisciplinary events such as *Innovation in Mind*. As part of these outreach activities, we have developed demonstration films and slideshows, for example on EEG research (A. Andersson, S. Sayehli), on linguistic corpus work (Burenhult et al.), and on 3D renderings of archeological material (S. Lindgren, C. Larsson).

We continue to offer introductory tours and demo sessions aimed at undergraduate and postgraduate programs, and at new Lund University employees. We also encourage teachers and supervisors to participate on these occasions. In 2014, we developed a new short course called *Introduction to the Humanities Lab* (Splendido et al), which allows novices to try out a number of things in the Lab. The course is held in spring 2015.

The Lab further organises a number of seminars on methodology (e.g., eye-tracking, statistics), on Digital tools in the Humanities, etc. that are open to all. As stated above, the Lab researchers also give a number of invited talks in various contexts, many of which showcase Lab activities and technologies.

The Lab web site has been updated to make information on policies, user agreements, how to participate in experiments, etc., easier to find. News coverage, blog and social media activities have improved to reflect the Lab activities. Printed promotional materials are available both in Swedish and English.

The expansion to LUX in 2014 has also lead to an update and implementation of a new booking system (2014 going live in Feb. 2015).

THE CORPUS SERVER, SWE-CLARIN

The Humanities Lab corpus server offers secure, long-term storage of structured and meta-described digital research data. The corpus server can also function as a collaborative workspace, where a group of researchers can download, edit, and upload data and metadata. Metadata are publicly visible, browsable, and searchable through the corpus browser, while the data themselves are password-protected.

In 2014 the Lab also became a Knowledge Centre in SWE-CLARIN (<http://sweclarin.se/>), a national consortium linked to the European CLARIN (<http://clarin.eu/>), a European Research Infrastructure Consortium (ERIC) devoted to developing language technology and language resources as e-science.



THE LARM STUDIO

The LARM studio (LARM= Ljud, Animation, Rörliga bilder, Musik, 'Sound, Animation, Moving images, Music') is a state of the art facility for professional level audio and video recordings of everything from musical and theatrical performances to talks, debates, and conversation. It can be used for research on these activities in themselves, but can also be used experimentally. The studio and control rooms are complemented by a data analysis and postprocessing facility.

The LARM studio has been equipped through generous funding from the Einar Hansen Allhems Foundation.





Visit by the Minister of higher education Helene Hellmark Knutsson (middle), the Dean Lynn Åkesson (left) and the Vice-chancellor of Lund University Thorbjörn von Schantz (right)

The Humanities Lab is the first lab of its kind in the world. Studies on the interplay between language, thought, communication and learning are examples of the important research that takes place there. The Joint Faculties of Humanities and Theology are proud to be able to provide researchers at Lund University and worldwide with such a facility.

– Lynn Åkesson, Dean

Conferences, Workshops and Symposia

Feb. 8, 2013

Eye-tracking group retreat
Skanör
Kenneth Holmqvist et al.

Feb. 17, 2013

Lund Eye-tracking Academy (LETA)
Humanities Lab, Lund
Kenneth Holmqvist et al.

March. 5, 2013

International workshop on real-world
eye-tracking
Zentrum für Interdisziplinäre For-
schung, Bielefeld
Kenneth Holmqvist

March. 6, 2013

International workshop on scanpath
similarity measures
Zentrum für Interdisziplinäre For-
schung, Bielefeld
Kenneth Holmqvist

April. 18, 2013

Place, landscape and language
Max Planck Institute for Psycholinguis-
tics, Nijmegen
Niclas Burenhult

April. 25, 2013

The Lund Legacy in the 21st Century:
Constructing a Digital Workspace and
Research Network for Austroasiatic
Intangible Heritage
Centre for Languages and Literature,
Lund

Niclas Burenhult, Nicole Kruspe, Felix
Ahlner, Jens Larsson, Marcus Uneson

May. 6, 2013

Cap training workshop
Humanities Lab, Lund
Annika Andersson

June. 5, 2013

Digital classroom workshop
Humanities Lab, Lund
Kenneth Holmqvist

June. 7, 2013

The interdisciplinary potential of langu-
age documentation
DOBES final conference at Herrenhau-
sen, Hannover
Niclas Burenhult

June. 12, 2013

Swedish Virtual Heritage School
Ingmar Kamprad Design Centre and
Centre for Languages and Literature,
Lund
Stefan Lindgren, Carolina Larsson

June. 17, 2013

Visual communication division, ICA
conference
London
Jana Holsanova

June. 6, 2013

Hunter-gatherers and language of
perception panel: 10th Conference on
Hunting and Gathering Societies

University of Liverpool, Liverpool
Niclas Burenhult

Aug. 7, 2013

ECEM Method Workshops
Centre for Languages and Literature,
Lund University, Lund
Marcus Nyström, Dan Witzner Hansen,
Fiona Mulvey, Kenneth Holmqvist,
Arantxa Villanueva

Aug. 11-16, 2013

ECEM 2013 – the 17th European Con-
ference on Eye Movements
Lund University, Lund
Kenneth Holmqvist, Fiona Mulvey et al.
plus international colleagues

Aug. 28, 2013

Ethnophysiology and landscape
linguistics
Lund University, Lund
Niclas Burenhult

Sept. 26, 2013

Lund Eye-tracking Academy (LETA)
Humanities Lab, Lund
Kenneth Holmqvist et al.

Oct. 24, 2013

Curry7 workshop
Humanities Lab, Lund
Annika Andersson, Richard Dewhurst

Nov. 25, 2013

Language Resources and Technology In-
frastructure: Language documentation,

multilingualism and multimodality
Humanities Lab, Lund
Marianne Gullberg, Niclas Burenhult

Dec. 2, 2013

Computer Applications and Quantitative Methods in Archeology
Akademiska Föreningen, Ingvar
Kamprad Design Centre, Lund
Maja Petersson, Stefan Lindgren

Feb. 17, 2014

Lund Eye-tracking Academy (LETA)
Humanities Lab, Lund
Kenneth Holmqvist et al.

March. 21, 2014

Grammatikdagen

Lund University, Lund
Susan Sayehli et al.

April. 30, 2014

Forskningsnätet Skåne and upper secondary school S.t Petri, Malmö
Lectures, demos and experiments
Victoria Johansson et al.

May. 5, 2014

Eye-tracking
Berlin-Teltow
Kenneth Holmqvist

June. 3, 2014

Eye-movements and eye-tracking
Vienna (Psychology and the Clever Dog
Laboratory)

Kenneth Holmqvist

Aug. 27, 2014

Multi-level modelling analysis of eye-movement data
Reinhold Kliegl's group, Potsdam
Kenneth Holmqvist

Sept. 21, 2014

Lund Eye-tracking Academy (LETA)
Humanities Lab, Lund
Kenneth Holmqvist et al.

Nov. 19-21, 2014

Culture, Brain, Learning
Lund University, Lund
Marianne Gullberg et al.

Lab Demos

In 2013, the lab gave 38 lab demos, and in 2014, 50. International visitors came from:

BRAZIL:

- University of Sao Paolo

CANADA:

- University of Alberta

CHINA:

- Hunan University

DENMARK:

- Copenhagen University
- Copenhagen Business School

FINLAND:

- Langnet National Doctoral Programme in Language
- Åbo Akademi

FRANCE:

- Université de Sorbonne Paris

GERMANY:

- Bielefeld University
- University of Greifswald

ITALY:

- University of Genoa

THE NETHERLANDS:

- Amsterdam Vrije Universiteit
- Leiden University
- University of Amsterdam

POLAND:

- Nicolaus Copernicus University in Torun

SLOVAKIA:

- University of Trnava

SPAIN:

- University of Barcelona
- University de Zaragoza

UNITED KINGDOM:

- University of London
- University of Manchester
- University of Nottingham
- University of York

USA:

- Stanford University
- Stony Brook University
- University of Maryland
- University of Oregon

National visitors came from:

- Anagram
- Directors from Swedish authorities
- Einar Hansens Allhemsstiftelse
- European Spallation Source ESS AB
- General public during HT-dagarna, Innovation in mind, Culture night
- Graduate School in Language Education, FRAM
- Kristianstad Länsmuseum
- Lund University Fund Raising Unit
- Lund University staff and students
- Nasoteket
- Scanian University Hospital
- Sydsvenska Dagbladet
- Swedish national level politicians
- Synsam
- The Birgit & Gad Rausing Foundation.
- The Marcus & Amalia Wallenberg Foundation
- Universitas 21

Courses and Lectures

The Lab offers courses, ranging from 2-hour short courses to courses accrediting students with 7,5 higher educational credits. Staff from the Lab is also often invited as guest lecturers in courses within and/or outside the university. During 2013-2014, the lab offered the following:

LONG COURSES

- 3D-scanning and post processing
- Computer Tools in the Humanities
- Creating a Language Corpus
- ERP Research Methods – Theory and Practice
- Eye Tracking
- Experimental design
- Programming for the Behavioural Sciences
- Statistical Analysis for Behavioural Science I and II

SHORT COURSES

- Audio and video lab
- CLAN analyses lab
- Ethics lab
- FRAM licentiate education
- GPS lab
- Prosody Praat lab

LECTURES

- Key-stroke logging and eye-tracking
- Articulography and Say after me
- VR and educational environments
- 3D-modelling with Blender
- Introduction to Unity3D
- 3D-digitalisation in cultural heritage
- Word
- Praat lab
- Articulography laboration
- Introduction to R
- Processing and analysis of articulo-graphic data
- Contrasts in categorical predictors
- Statistical analysis and statistical significance
- Unity3D, 3D-scanning, Blender
- Introduction to articulography and demo of the AG500 and AG501
- Experiment design and planning
- Fixational eye movements
- Linguistic field methods

SUMMER SCHOOL (2013)

- Multimodal multilingualism: AHRC skills development scheme: Skills development for language research and teaching in a multilingual world
- International graduate course Multimodal multilingualism

Consulting

The lab also offers consultations on programs, technology and analysis. Lab members provided expert input to requests both from within and outside Lund University on 50 occasions during 2013 and 62 in 2014. The consultations were within the following areas:

- 3D scanning, analysis and application
- Audio recording
- Big data analysis
- Bio Pac instructions
- Comments on investigations regarding easy reading
- Data storage and databases
- E-prime
- ERP recording, analysis and application
- Event detection and visualising
- Eye Tracking analysis and maintenance
- Experimental set ups and analysis
- Grant application training
- MatLab scripting and coaching
- Motion Capture recording, analysis and application
- Netlogo recording
- Praat
- PsychoPy
- R analysis
- Recording
- Say after me
- Software improvement analysis
- Statistical consultation and analysis
- Syllabified lexicons consultation
- Various scripts for analyzing data and creating tests
- Web-based perception tests consultation

Collaborations

- The Cyprus Institute, Nicosia
- Dalby parish, Dalby
- Dan W Hansen ITU, DK, and Utrecht University, Netherlands
- Department of archeology, Lund university, and Stora Karlsö
- EMRA – the Eye Movement Researchers Association
- Eye clinic, Lund University Hospital
- Forskningsnätet Skåne and upper secondary school S:t Petri, Malmö
- Gebel el Silsila survey project (through the Archeological institution, Lund University)
- The Institute of Information Science and Technologies (ISTI), Pisa
- Image Analysis Centre, University of Uppsala
- Kristianstads museum, Kristianstad
- Kulturen Museum, Lund University
- Malmö Academy of Music, Malmö
- Max Planck Institute for Psycholinguistics
- MSE Weibull AB, Älmhult
- Museum of History, Stockholm
- Nottingham University
- Open University of the Netherlands
- Optician chain, Lund
- PIRE Network
- Pontifical Catholic University of Peru
- Riksantikvarieämbetet and Kulturen, Lund
- San Diego State University/University of California at Irvine/Barona Cultural Center and Museum
- School of English, Media Studies

- and Art History (EMSAH), University of Queensland, Brisbane
- SensoMotoric Instruments, Berlin
- Seminario Italiano di Linguistica e Letteratura (SILL)
- Skriv- och läscentrum, Helsingborg
- The State University of New York
- Svenskt Hällristningsarkiv, at
- Österlens museum, Simrishamn
- Swedish Pompeji Project at Millesgården, Stockholm
- Trelleborgs museum, Trelleborg
- SWE-CLARIN
- Swedish Church
- Universitet Pompeu Fabra
- University of Verona
- Vattenhallen Science Centre, Lund
- Vestibular Laboratory, Lund University
- Zentrum für Interdisziplinäre Forschung, Bielefeld
- Österlens museum, Simrishamn

Conference Presentations

FEB. 28, 2013

Domain-driven documentation: The case of landscape
International Conference on Language Documentation and Conservation
Honolulu
Niclas Burenhult

MARCH. 6, 2013

The effect of task difficulty on eye-movement sequences in Multiple Dimensions Competition and Priority control in Mind & Brain: New Perspectives from Task Driven Vision
Zentrum für Interdisziplinäre Forschung, Bielefeld
Richard Dewhurst

MARCH. 23, 2013

L1/L2 differences in processing verbal vs. adjectival short passive constructions
Conference 26th Annual CUNY Conference on Human Science Processing
Columbia, SC, USA
Damon Tutunjian, Marianne Gullberg

APRIL. 6, 2013

Morpho-syntactic transfer in L3 acquisition
General Linguistics in the Old World (GLOW) 36
Lund
Susan Sayehli

APRIL. 13, 2013

The role of age of acquisition and proficiency on nonword rhyming in 6- to 8-year-old bilingual children
Cognitive Neuroscience Society Meeting
San Francisco, USA
Annika Andersson

APRIL. 18, 2013

Landscape compounds in Övdalian
Place, landscape and language
Max Planck Institute for Psycholinguistics, Nijmegen
Felix Ahlner

APRIL. 19, 2013

Features, places and motion in the Jahai landscape
Place, landscape and language
Max Planck Institute for Psycholinguistics, Nijmegen
Niclas Burenhult

JUNE. 1, 2013

Mapping and indigenous landscape categories
Landscape through the prism of language
Zurich
Niclas Burenhult

JUNE. 10, 2013

Data management in Lund University Humanities Lab
Workshop on Data Management and Workflow, eSENCE@LU and the Vice Chancellor's office
Lund
Marianne Gullberg

JUNE. 14, 2013

Functional data analysis of tongue articulation in Gothenburg and Malmöhus Swedish
Fonetik 2014
Linköping
Susanne Schötz, Johan Frid

JUNE. 14, 2013

A phonetic pilot study of chirp, chatter, tweet and tweedle in three domestic cats
Fonetik 2014
Linköping
Susanne Schötz

JUNE. 15, 2013

Developmental stages and transfer in L3 acquisition
Nordand 11: Den 11:e konferensen om Nordens språk som andraspråk
Stockholm
Susan Sayehli

JUNE. 19, 2013

Gesture production and speech fluency in competent speakers and language learners
Tilburg Gesture Research Meeting (TiGeR)
Tilburg
Maria Graziano, Marianne Gullberg

AUG. 23, 2013

Reflections on education's digital future
Technologies for learning
Helsinki
Marianne Gullberg

AUG. 27, 2013

Functional data analysis of tongue articulation in palatal vowels: Gothenburg and Malmöhus Swedish
Interspeech 2013
Lyon
Susanne Schötz, Johan Frid

AUG. 28, 2013

The interaction between developmental stages and transfer in L3 acquisition: Evidence from spontaneous speech and elicited imitation tasks
EUROSLA 23
Amsterdam
Susan Sayehli

SEPT. 19, 2013

How can we learn with pictures?
Innovations of mind
Lund
Jana Holsanova

SEPT. 20, 2013

Transfer and L3 acquisition
13th International Symposium on Processability Approaches to Language Acquisition
Lund
Susan Sayehli

OCT. 17, 2013

Panel discussion: Big data and e-science
eSENCE Academy 2013 in Lund
Lund
Victoria Johansson

OCT. 24, 2013

Developmental perspectives on transfer
International Conference on Multilingualism
Montréal, Canada
Susan Sayehli

OCT. 28, 2013

3d laser scanning in cave environment in the case of Las Cuevas, Belize
Digital Heritage conference
Marseille
Stefan Lindgren

NOV. 2, 2013

Do language learners (and competent speakers) gesture during expressive difficulties?
Boston University Conference on Language Development (BUCLD 38)
Boston
Maria Graziano, Marianne Gullberg

NOV. 13, 2013

e-Science and e-Infrastructure in the humanities now and tomorrow
eSENCE/LU workshop on informatics and e-infrastructure
Lund
Marianne Gullberg

DEC. 4, 2013

Combining 3D-data from 3D-scanning and aerial photogrammetry
Computer Applications and Quantitative Methods in Archaeology (CAA-SE)
Lund
Stefan Lindgren

APRIL. 5, 2014

Effects of age acquisition (AoA) and proficiency on processing of syntax in 6- to 8-year old monolingual and bilingual children; an ERP study
Cognitive Neuroscience Society Meeting
Boston
Annika Andersson

APRIL. 11, 2014

En sanning om läppläsning
HT-dagarna
Centre for Languages and Literature,
Lund University
Richard Andersson

APRIL 11, 2014

Hur sanna kan datorgenererade historiska miljöer vara?
HT-dagarna
Centre for Languages and Literature,
Lund University
Stefan Lindgren

APRIL. 11, 2014

Sanningen sitter i detaljerna. ERP-data i språkstudier
HT-dagarna
Centre for Languages and Literature,
Lund University
Susan Sayehli

JUNE. 20, 2014

Can observational learning improve argumentative text writing in students with hearing impairment?
International Clinical Linguistics and Phonetics Association Conference
Stockholm
Joost van de Weijer

JULY. 11, 2014

When speech stops, gesture stops: Evidence from cross-linguistic and developmental comparisons
International Society for Gesture Studies (ISGS 6)
San Diego
Maria Graziano, Marianne Gullberg

AUG. 27, 2014

Effects of age of acquisition (AoA) and proficiency on processing of syntax in 6- to 8-year old monolingual and bilingual children: An ERP study
Society for the Neurobiology of Language
Amsterdam
Annika Andersson

AUG. 27, 2014

Today read she the paper: An ERP study of the processing of word order in Swedish L2
Society for the Neurobiology of Language
Amsterdam
Susan Sayehli, Annika Andersson, Marianne Gullberg

SEPT. 3, 2014

Today read she the paper: An ERP study of the processing of word order in Swedish as a second language
Eurosla 24
York
Susan Sayehli, Annika Andersson, Marianne Gullberg

NOV. 19, 2014

Language background affects word order processing in a second language online but not offline
Culture, Brain and Learning
Lund
Annika Andersson, Susan Sayehli, Marianne Gullberg

NOV. 20, 2014

Diversity and the language/culture interface: The case of landscape
Culture, Brain and Learning
Lund
Niclas Burenhult

Invited Talks and Guest Lectures

JAN. 21, 2013

The phonetic research in the Humanities Lab
St. Petri High School, Malmö
Susanne Schötz, Elisabeth Zetterholm

MARCH. 19, 2013

Gesto e parola: aspetti inseparabili della comunicazione nell'interazione faccia a faccia
Stockholm university
Maria Graziano

MARCH. 21, 2013

Lo sviluppo della gestualità
Stockholm university
Maria Graziano

MARCH. 22, 2013

Hjärnans plasticitet och grammatik
Lund University
Annika Andersson

APRIL. 18, 2013

Go Global
International Unit, Lund university
Stefan Lindgren

APRIL. 19, 2013

Cat vocalisations: Vad säger katten? Om mjao, kurr och andra kattljud
Lund University
Susanne Schötz

APRIL. 23, 2013

La commedia dell'arte Italiana (popular talk)
Dante Alighieri Society, Ängelholm
Maria Graziano

APRIL. 26, 2013

Barns andraspråkinläring
Klurifax förskola, Hörby
Annika Andersson

MAY 7, 2013

Experimental design and eye-tracking methodology, eye-tracking measures
Tobii Technologies, Stockholm
Kenneth Holmqvist

MAY. 8, 2013

Developmental perspectives on transfer in third language acquisition
Malmö högskola, Department of Language and Linguistics, Malmö
Susan Sayehli

JUNE. 5, 2013

EMA research at Lund Humanities Lab: Dialectal and development variation?
Ludwig-Maximilians-Universität, Munich
Susanne Schötz, Johan Frid

JULY. 9, 2013

The relationship between speech and gesture in the development of pragmatic and textual abilities
Entwicklungsgruppe Klinische Neuropsychologie (EKN)
Munich
Maria Graziano

SEPT. 10, 2013

Picture or a thousand words?
UR Samtiden
Jana Holsanova

SEPT. 17, 2013

La gestualità in Italia
Dante Alighieri Society, Helsingborg
Maria Graziano

SEPT. 26, 2013

Att lära sig språk. Nyttan och glädjen
Nya Malmö Latin high school, Malmö
Susan Sayehli

SEPT. 28, 2013

Samspel mellan språk och bilder
Book fair, Gothenburg
Jana Holsanova

NOV. 8, 2013

Relazione tra gesto e disfluenze del parlato in apprendenti L1 e L2
Seminario Italiano di Linguistica e Letteratura (SILL), Lund
Maria Graziano

NOV. 12, 2013

L2 processing of short passive constructions in English
Department of German and English, Barcelona
Damon Tutunjian

NOV. 18, 2013

Digital humanities – a view from Sweden
School of English, Media Studies and Art History (EMSAH), University of Queensland, Brisbane
Stefan Lindgren

DEC. 10, 2013

Gesture production and speech fluency in competent speakers and language learners
Language Acquisition Research Group Seminar, Lund
Maria Graziano and Marianne Gullberg

MARCH. 4, 2014

Eye-movements and learning: From vector calculus to dyslexia
Cognition, Communication and Learning
Psychology department, Lund
Marcus Nyström

MARCH. 10, 2014

Humanities Lab research and facilities
SFIS (Svenska Föreningen för Informationsspecialisterna)
Annual meeting
Lund
Annika Andersson et al.

MARCH. 21, 2014

Enspråkiga och tvåspråkiga barns bearbetning av grammatik
Lund
Annika Andersson

MARCH. 31, 2014

Lund University Humanities Lab: research, training, interaction
The deans of the College of Liberal Arts, UT University of Texas at Austin
Marianne Gullberg

APRIL. 7, 2014

The relationship between speech and gesture in face-to-face communication
Malmö Art Academy, Malmö
Maria Graziano et al.

APRIL. 11, 2014

Il significato di alcuni gesti in Italia
Svensk-italienska föreningen, Göteborg
Maria Graziano et al.

MAY. 14, 2014

3d-scanning av världsarv
Världsarvdagen, Karlskrona
Stefan Lindgren et al.

JULY. 1, 2014

Eye-tracking and eye-movement research
Beijing
Kenneth Holmqvist

SEPT. 10, 2014

La commedia dell'arte in Italia
Dante Alighieri Society, Helsingborg
Maria Graziano et al.

SEPT. 15, 2014

Digital Multimedia Corpora
Digital Humanities Seminar, Lund
Niclas Burenhult et al

SEPT. 26, 2014

Att förstå hjärnans språk: Vad händer egentligen när vi talar och förstår ett språk?
Europeiska språkdagen
Nya Malmö Latinskola, Malmö
Susan Sayehli et al.

OCT. 14, 2014

An ERP study of the processing of Swedish word order in Swedish L2 Language Acquisition
Lund
Susan Sayehli, Annika Andersson, Marianne Gullberg and others

OCT. 15, 2014

From eye-tracking group to service laboratory
Essence Academy, Umeå
Kenneth Holmqvist

OCT. 20, 2014

Talks at COMPUTE research school
Lund University COMPUTE research school, Department of Astronomy, Faculty of Science
Marianne Gullberg, Annika Andersson, Marcus Nyström, Victoria Johansson, Nicolo Dell'Unto

OCT. 22, 2014

Does eye-movement training help dys-
lectic readers?

Section for Pedagogical Support, Lund
University
Marcus Nyström

OCT. 30, 2014

Introduction to ELAN: Transcription,
coding and analyses

Institute for German as a Foreign Language,
University of Munich
Maria Graziano et al.

NOV. 4, 2014

Developmental perspectives on transfer
in L3 acquisition

Institutionen för svenska språket, Lin-
néuniversitetet, Växjö
Susan Sayehli et al.

NOV. 13, 2014

Fixational eye-movements in normal
populations

Seminar for Swedish eye physicians
Lund
Marcus Nyström

NOV. 25, 2014

Uso e significato di alcuni gesti italiani
Dante Alighieri Society, Lund

Maria Graziano et al.

DEC. 2, 2014

Does eye-movement training help dys-
lectic readers?

Skriv- och läscentrum, Helsingborg
Marcus Nyström et al.

Seminar series

EYE TRACKING SEMINAR

Humanities Lab, Lund

DIGITAL TOOLS IN THE HUMANITIES

Joint Faculties for the Humanities and Theology, Lund

Research Grants and Awards

MARIANNE GULLBERG

Instrumentation of new studio at LUX

Einar Hansens Allhemsstiftelse

DAMON TUTUNJIAN

Cognitive constraints on sentence processing

Crafoordska Stiftelsen

DAMON TUTUNJIAN

L1/L2 differences in processing verbal vs. adjectival passive
constructions

Kungl. Vitterhetsakademien – Västeuropastipendier

MARCUS NYSTRÖM, PAUL MCGRAW AND NEIL ROACH

Support for Joint Research between Lund University of Not-

tingham, UK, Project title: "Quantifying the contribution of
FEMs to the analysis of simple and more complex image fea-
tures and characterizing the mechanisms that compensate for
FEMs to provide a stable representation of the visual world"

Lund University

STEFAN LINDGREN

Initiating a U21 collaboration to examine the possibilities of
combining indigenous art and augmented reality

Knut And Alice Wallenbergs foundation

RICHARD ANDERSSON

International post-doc grant, two years

Vetenskapsrådet

Visitors

Jan. 16 - 18, 2013

Moiken Jessen

Odense, Denmark

Jan. 17 - March. 21, 2013

Jan. 15 - March. 31, 2014

Ignace Hooge

Utrecht University

Jan. 28 - Feb. 2, 2013

Martje Wijers

Leuven University

March. 11 - 13, 2013

Peter Indefrey

Heinrich Heine University Düsseldorf /Donders Institute for Brain, Cognition and Behaviour

March. 1 - May. 24, 2013

Tim Cornelissen

Utrecht University

April. 1 - 30, 2013

Stanislav Popelka

Palacký University

April. 3 - 16, 2013

Eric Pedersen

University of Oregon

April. 22 - 24, 2013

Gerd Berget

Oslo and Akershus University

April. 25 - May. 9, 2013

Daniele Ferdani

CNR-ITABC (Istituto per le Tecnologie Applicate ai Beni Culturali)

Virtual Heritage Lab, Rome

April. 29, 2013

Sara Goico

University of California Santa Barbara

May. 13 - 31, 2013

Alex Cobbinah, Rachel

Watson

SOAS

University College London

May. 20 - 22, 2013

Judith Holler

Max Planck Institute for Psycholinguistics

June. 11 - July. 11, 2013

Fabrizio Galeazzi

University of California Merced

June. 24 - 28, 2013

Inge Alferink

Nijmegen, Netherlands

Aug. 26 - Sept. 2, 2013

Giannis Vrellis

Virtual Realities Technologies Lab, University of Ioannina, Greece

Aug. 28, 2013

Konrad Rybka

University of Amsterdam

Sept. 16, 2013

Flurina Wartmann

University of Zurich

Jan. 8 - June. 30, 2014

Dong Wang

Rochester Institute of Technology

Jan. 1, 2014 - Jan. 30, 2015

Raimondas Zemblys

Lithuania

Feb. 2 - 6, 2014

Chris Scholes

University of Nottingham

Feb. 12 - 14, 2014

David Wilkins

Stockholm University

March. 17 - July. 15, 2014

Moiken Jessen

Syddansk universitet Odense

April. 1, 2014

Zaheer Ahmed

IT University, Copenhagen

May. 5 - 30, 2014

Gareth Carroll

University of Nottingham

May. 8 - July. 1, 2014

Julia Hotchner

Partnerships for International Research and Education (PIRE), Penn State

May. 20, 2014

Colin Philips

University of Maryland

July. 24, 2014

Paul McGraw, Neil Roach,

Chris Scholes

University of Nottingham

July. 24, 2014

Ellen Kok

Maastricht

Aug. 11 - Sept. 30, 2014

Yu Ying

Taiwan

Sept. 1, 2014 - April. 15, 2015

Alena Holubcová

Masaryk University, Brno

Oct. 15 - Dec. 19, 2014

Olga Kushch

Universitat Pompeu Fabra, Barcelona

Staff members during 2013-2014

Felix Ahlner PhD student, laboratory assistant	Maria Graziano researcher	Jens Larsson project assistant	Alexander Strukelj PhD student, laboratory assistant
Annika Andersson researcher	Josine Heleen Greidanus project assistant	Stefan Lindgren research engineer	Frida Splendido pedagogical developer
Richard Andersson researcher	Marianne Gullberg director	Fiona Mulvey researcher	Damon Tutunjian postdoc
Carolina Ask student assistant	Lars Gustafsson programmer	Jens Nirme PhD student	Joost van de Weijer methodologist
Kristina Borgström PhD student, laboratory as- sistant	Clair Hill researcher	Marcus Nyström researcher	Cecilia Whitehorn financial administrator
Niclas Burenhult researcher	Nils Holmberg PhD student, laboratory assistant	Manuel Oliva PhD student, project assistant	Raimondas Zemblys postdoc
Richard Dewhurst researcher	Martina Holmgren administrative assistant	Azra Padjan administrative assistant	Victoria Åkerlund project assistant
Love Eriksen researcher	Kenneth Holmqvist researcher	Maja Petersson administrative coordinator	
Sara Farshchi PhD student, project assistant	Jana Holsanova researcher	Peter Roslund research engineer	
Johan Frid researcher	Caroline Hägerhäll researcher	Åsa Sang researcher	
Henrik Garde programmer	Victoria Johansson researcher, IT-pedagogue	Susan Sayehli researcher	
Kerstin Gidlöf researcher	Carolina Larsson project assistant	Susanne Schötz researcher	

Funders

- CRAFOORDSKA STIFTELSEN
- EINAR HANSENS ALLHEMS STIFTELSE
- KNUT OCH ALICE WALLENBERGS STIFTELSE
- LUNDBORGSKA IDO-FONDEN
- PETER WALLENBERGS STIFTELSE
- STIFTELSEN MARCUS OCH AMALIA
WALLENBERGS MINNESFOND
- VETENSKAPSRÅDET





ANNUAL REPORT, HUMANITIES LAB, LUND UNIVERSITY

PRODUCTION: Humanities Lab, Lund University

TEXT: Marianne Gullberg

LAYOUT: Maja Petersson

PHOTO: Maja Petersson, Annika Andersson, Carolina Larsson, Richard Dewhurst, Stefan Lindgren, Susanne Ewert

PRINT: Media Tryck, Lund, 2015



LUNDS
UNIVERSITET

www.humlab.lu.se

LUND UNIVERSITY

PO Box 117
SE- 221 00 Lund
Sweden
+45 46-222 00 00
www.lu.se